

Maldives Land and Survey Authority,

MINISTRY OF HOUSING AND INFRASTRUCTURE

Ameenee Magu, Maafannu, Male', 20392, Maldives.

Office (PABX): +(960) 3004300, Fax: +(960) 3004254

Email: survey@mhe.gov.mv

Web: www.surveyofmaldives.gov.mv, www.mhe.gov.mv



CONTROL POINT DETAILS	Station Number	PSM 5481
Coordinate Information		
Geodetic	Grid	
WGS 84	UTM Zone 43	
Lat:	E:	264753.109m
Long:	N:	442759.631m
Ellp Height:	Orth Height:	1.493m
Island Name:	Date:	A.A. Kandholhudhoo 25th December 2012

Monument description & method of survey:

- o Type A monument
- The coordinates (E, N) was derived from the traverse by using PSM 5483 as a base reference.
- o Level was determined using tide data provided by MAT.

General site condition & access:

- o PSM5481 was established in the vegetation line of the island.
- o PSM5481 is located near the water villas
- o PSM5481 is located in an area which is easy to access and locate.

Owner: Universal Enterprises Pvt. Ltd.

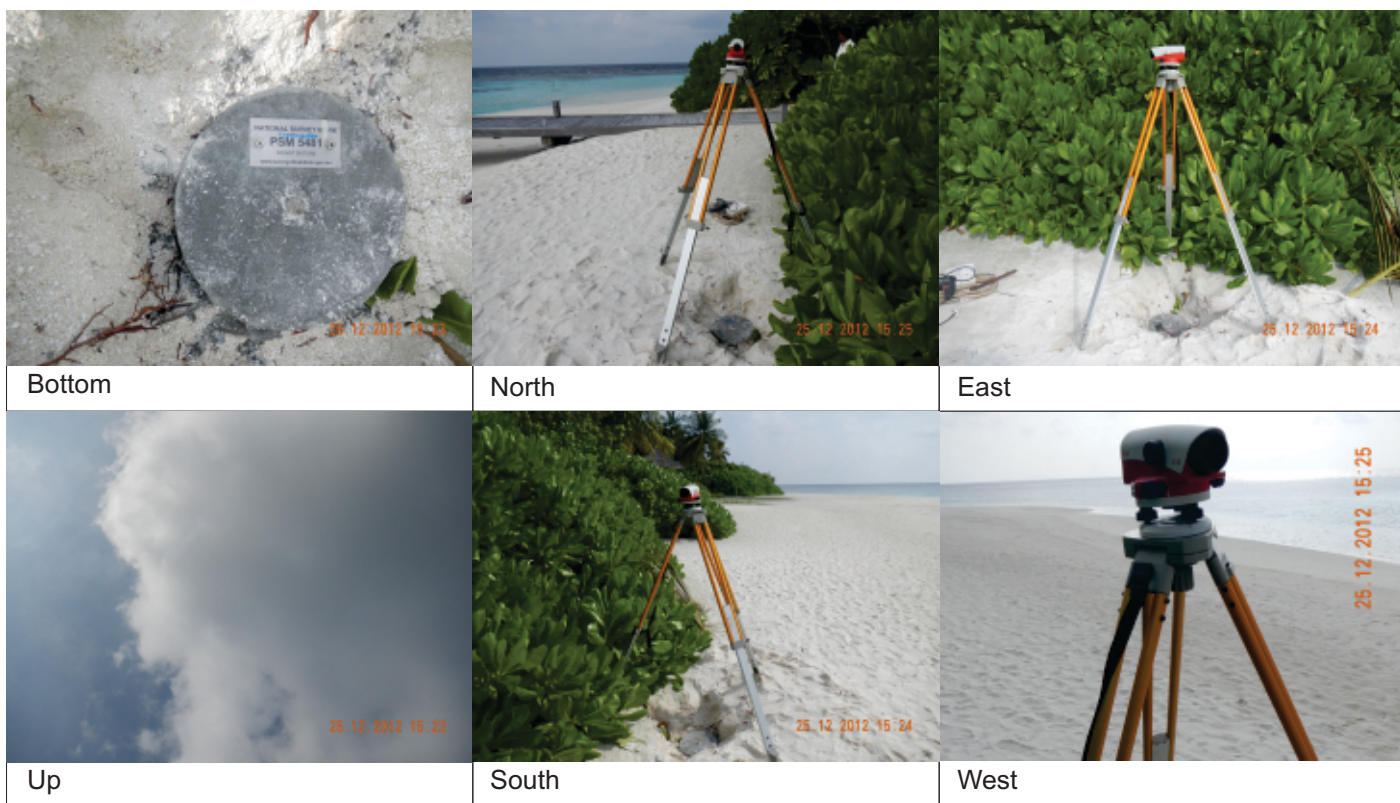

SITE INFORMATION

Station Number

PSM 5481

Station Horizon Mask

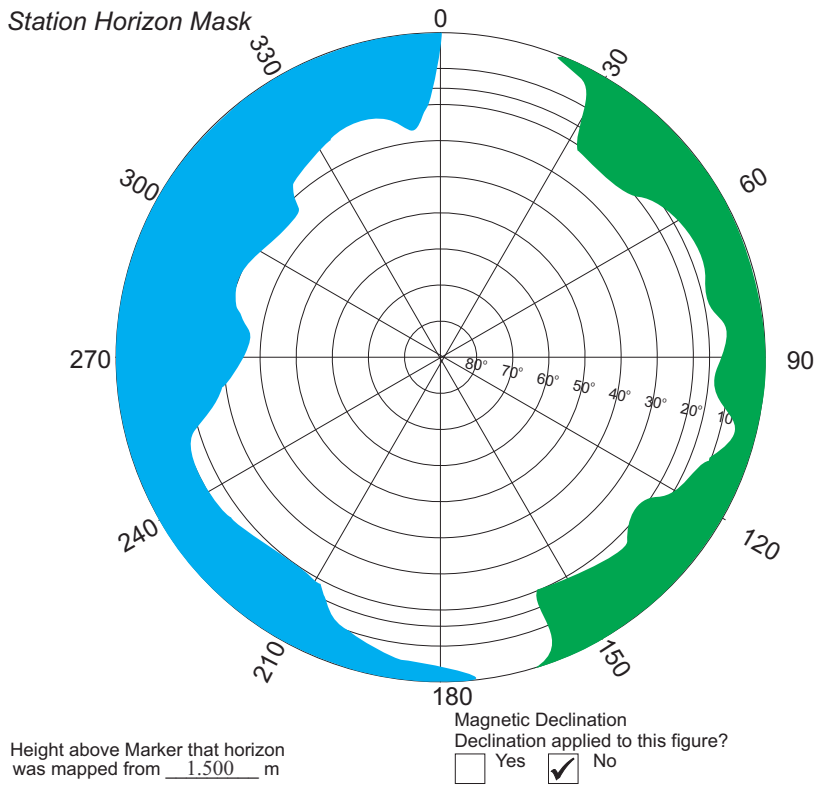

Locality

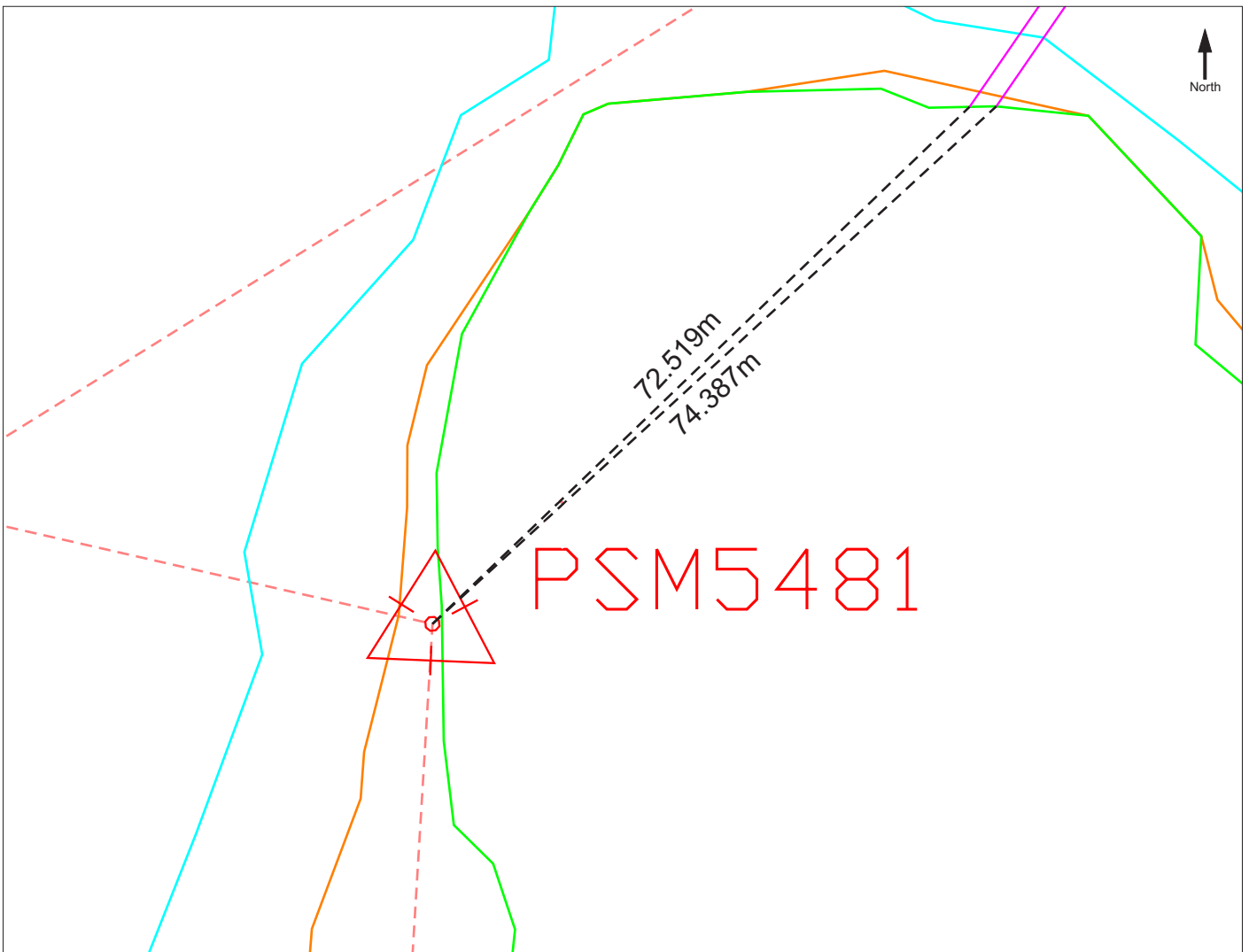
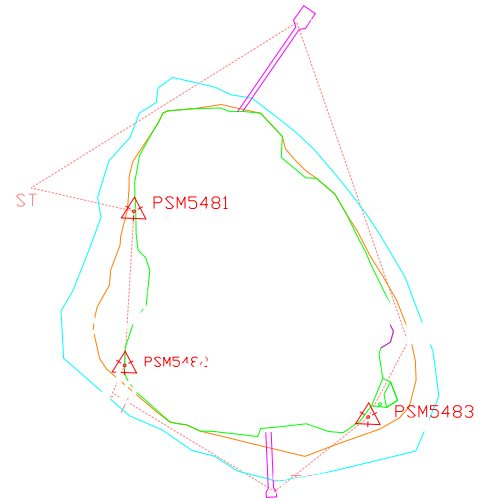

Sketched by: Abulho

Scale: Not to scale

Date: December, 2012

Maldives Land and Survey Authority,

MINISTRY OF HOUSING AND INFRASTRUCTURE

Ameenee Magu, Maafannu, Male', 20392, Maldives.

Office (PABX): +(960) 3004300, Fax: +(960) 3004254

Email: survey@mhe.gov.mv

Web: www.surveyofmaldives.gov.mv, www.mhe.gov.mv



CONTROL POINT DETAILS	Station Number PSM 5482
Coordinate Information	
Geodetic	Grid
WGS 84	UTM Zone 43
Lat:	E: 264748.297m
Long:	N: 442682.079m
Ellp Height:	Orth Height: 1.256m
Island Name: A.A. Kandholhudhoo	Date: 25th December 2012

Monument description & method of survey:

- o Type A monument
- o The coordinates (E, N) was derived from the traverse by using PSM 5483 as a base reference.
- o A level double run was recorded using PSM 5481 as the base, vertical control levels of PSM 5482 was determined from the level circuit

General site condition & access:

- o PSM5482 was established in the vegetation line of the island.
- o PSM5482 is located at the south west corner of the island
- o PSM5482 is located in an area which is easy to access and locate.

Owner: Universal Enterprises Pvt. Ltd.

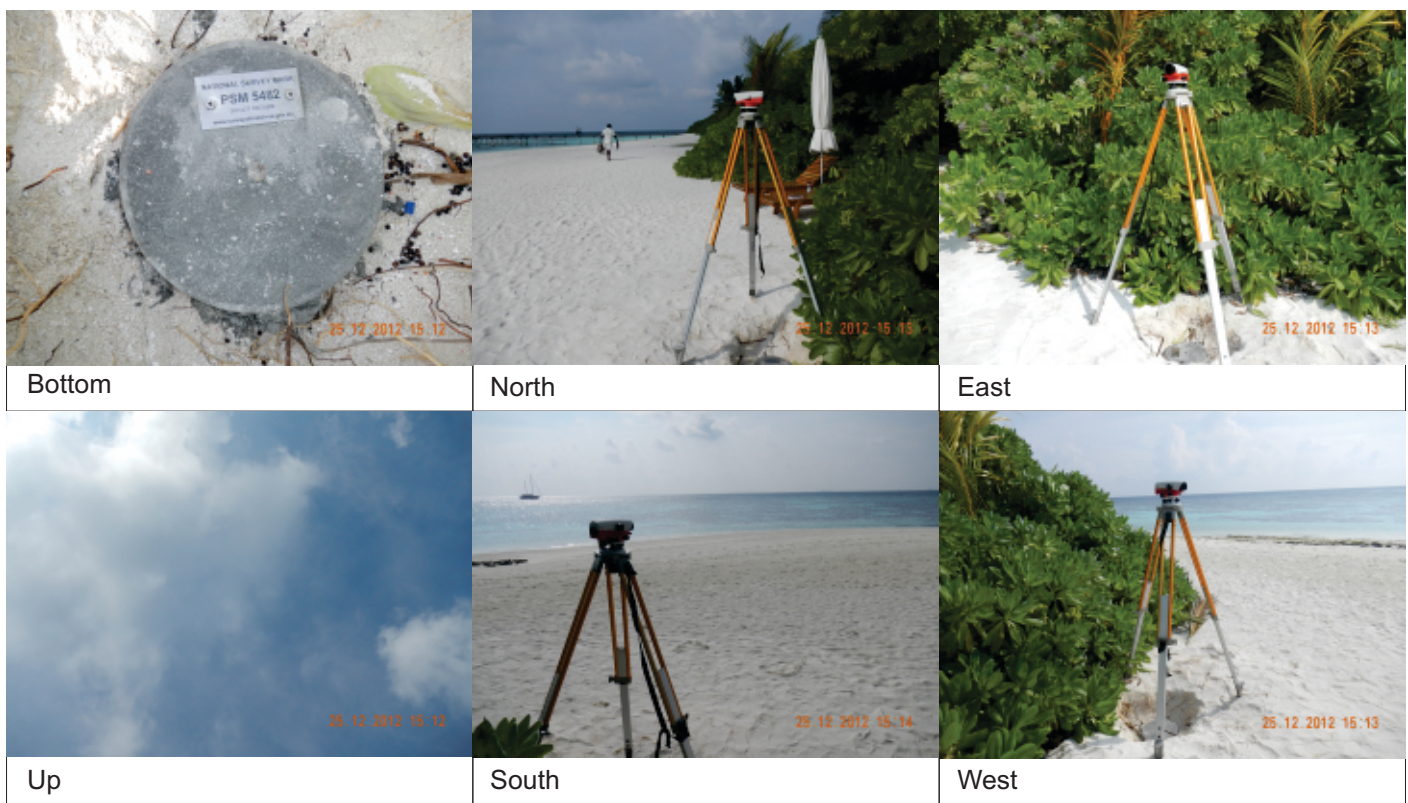

SITE INFORMATION

Station Number

PSM 5482

Station Horizon Mask

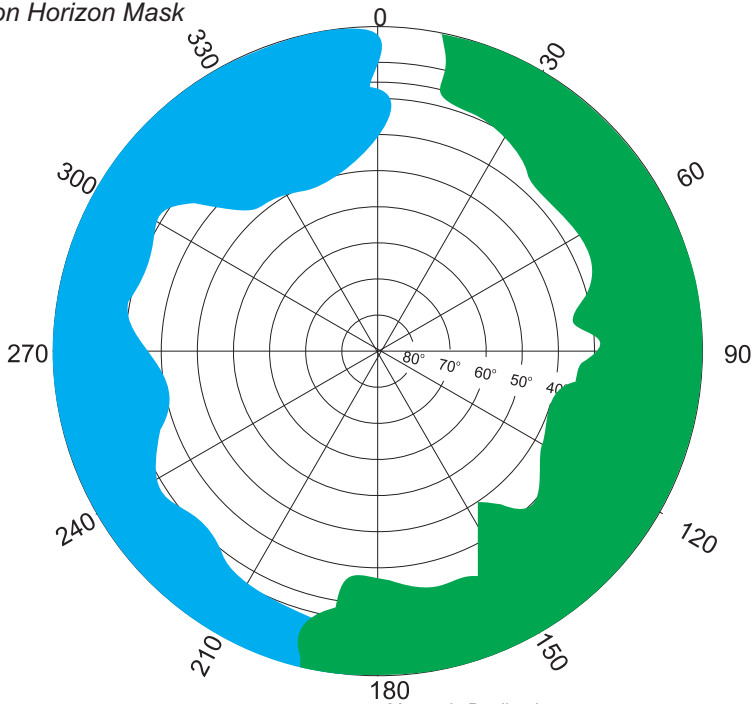

Locality

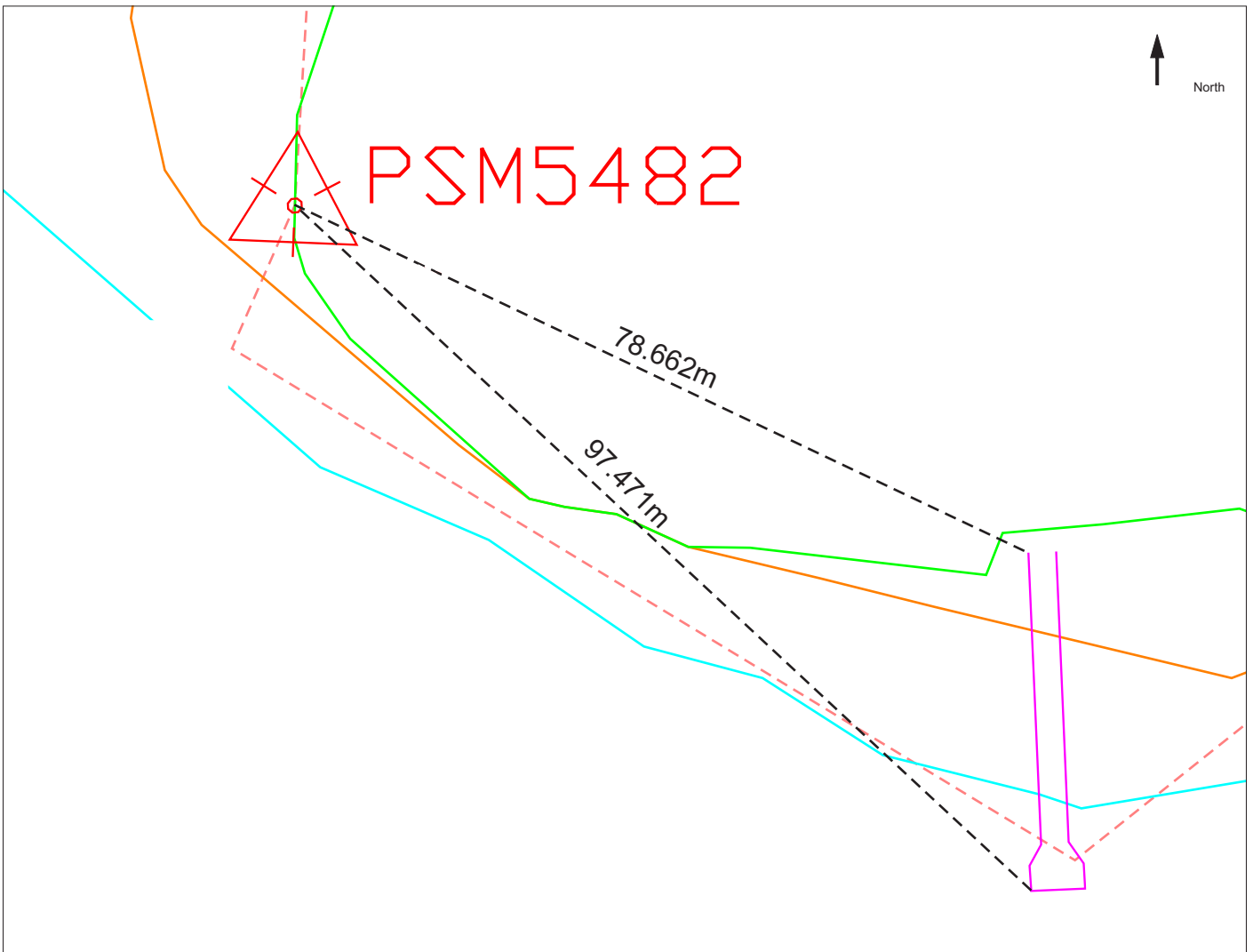
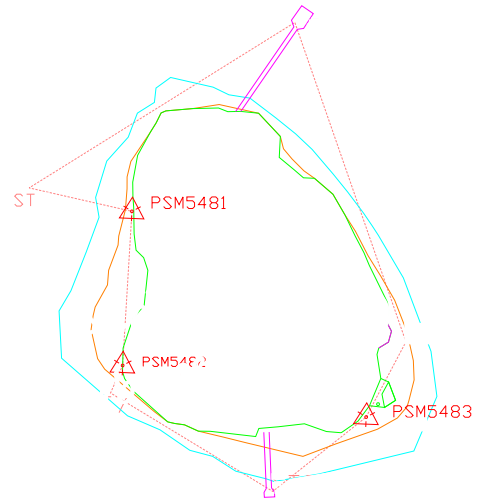

Sketched by: Abulho

Scale: Not to scale

Date: 25th Aug. 2012

Maldives Land and Survey Authority,

MINISTRY OF HOUSING AND INFRASTRUCTURE

Ameenee Magu, Maafannu, Male', 20392, Maldives.

Office (PABX): +(960) 3004300, Fax: +(960) 3004254

Email: survey@mhe.gov.mv

Web: www.surveyofmaldives.gov.mv, www.mhe.gov.mv



CONTROL POINT DETAILS		Station Number	PSM 5483
Coordinate Information			
Geodetic		Grid	
WGS 84		UTM Zone 43	
Lat:	4° 0'7.33"N	E:	264870.963m
Long:	72°52'56.30"E	N:	442655.899m
Ellp Height:		Orth Height:	0.989m
Island Name: A.A. Kandholhudhoo		Date: 25th December 2012	

Monument description & method of survey:

- o Type A monument
- o The coordinates (E, N) is Geo referenced using Leica System 500 GPS
- o A level double run was recorded using PSM5481 as the base, vertical control levels of PSM5483 was determined from the level circuit.

General site condition & access:

- o PSM5483 was established in the vegetation line of the island.
- o PSM5483 is located at the south west corner of the island
- o PSM5483 is located in an area which is easy to access and locate.

Owner: Universal Enterprises Pvt. Ltd.



SITE INFORMATION

Station Number

PSM 5483

Station Horizon Mask

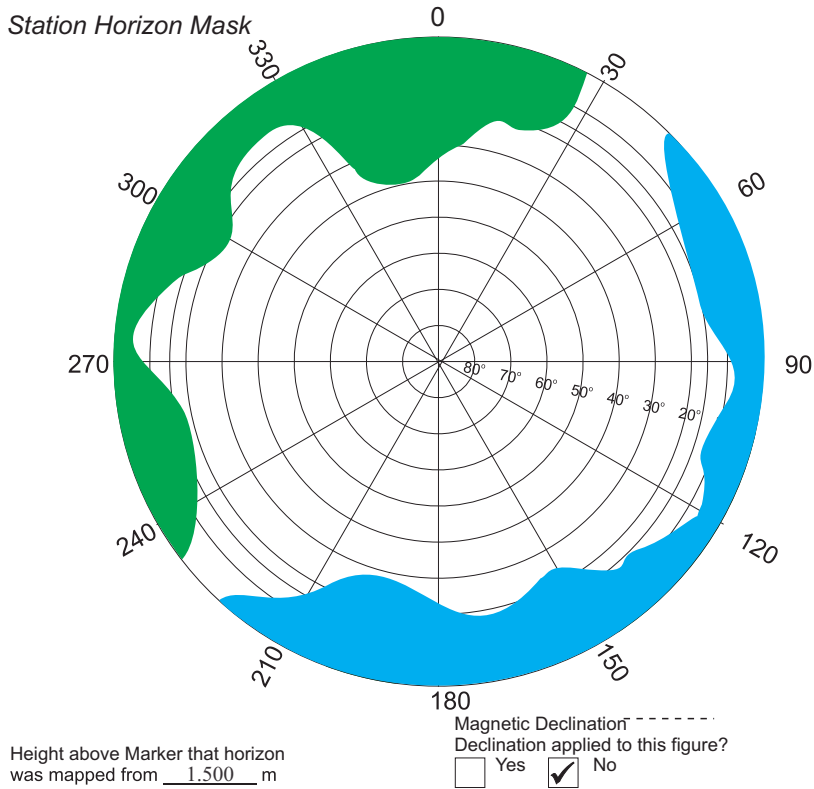

Locality

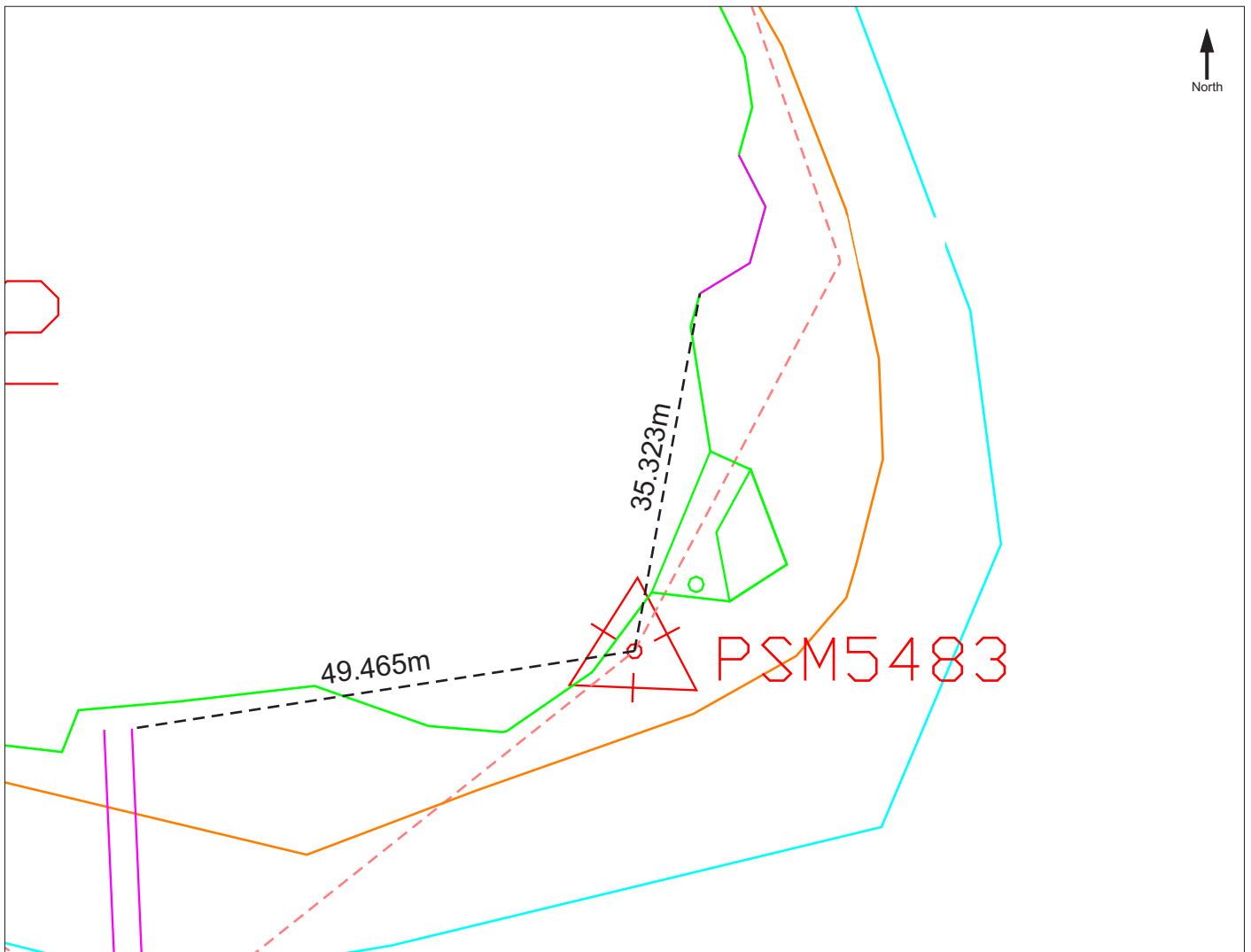
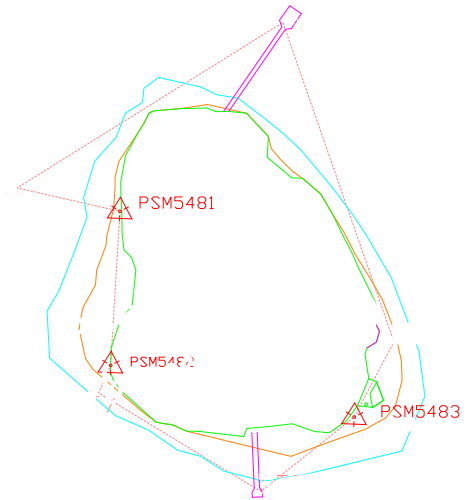

Sketched by: Abulho

Scale: Not to scale

Date: December, 2012